

Natural Playground - sc. 1:200

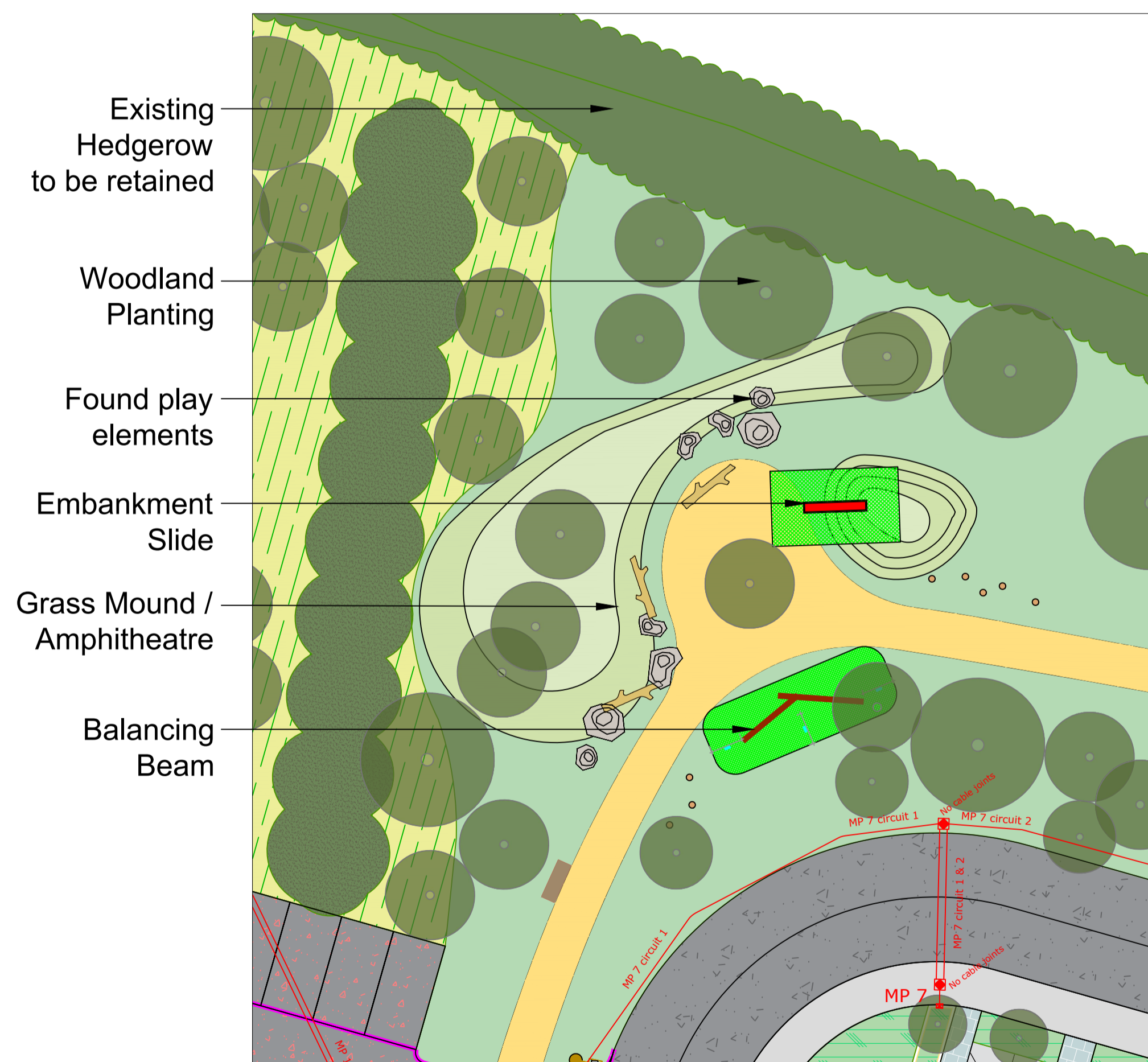

- SOFT LANDSCAPE**
Existing Hedgerows: Retained
- Proposed Tree Planting - 1509 No. Total**
- | Common Name | Species Name | Specification |
|----------------------|------------------------------------|-----------------|
| Norway Maple | <i>Acer platanoides</i> 'Columnar' | r/b 12-14cm gt. |
| Paperbark Maple | <i>Acer griseum</i> | r/b 16-18cm gt. |
| Birch | <i>Betula pendula</i> * | r/b 16-18cm gt. |
| Common Hazel | <i>Corylus avellana</i> * | r/b 16-18cm gt. |
| Ornamental Crabapple | <i>Malus 'John Downie'</i> | r/b 12-14cm gt. |
| London Plane | <i>Platanus x acerifolia</i> | r/b 18-20cm gt. |
| Wild Cherry | <i>Prunus avium</i> 'Plena' | r/b 14-16cm gt. |
| Birch Bark Cherry | <i>Prunus serrula</i> 'Tibetica' | r/b 12-14cm gt. |
| White beam | <i>Sorbus aria</i> | r/b 14-16cm gt. |
| Small-leaved Lime | <i>Tilia cordata</i> 'Greenspire' | r/b 16-18cm gt. |
| Cypress Oak | <i>Quercus robur</i> 'Koster' | r/b 16-18cm gt. |
- G1 Amenity Grass** (300mm topsoil depth)
Coburn's Low Maintenance seed
- G2 Mounded Amenity Grass** (300mm topsoil depth)
Coburn's Low Maintenance seed, Grass Mound - max 1m height

- B1 - Seasonal Bulbs** (300mm topsoil depth)
Bulb planting in grass to be incorporated at 10 bulbs per sq. metre. Mowing to be reduced in accordance with suppliers instructions.
- With flowering bulbs, including:
Colchicum autumnale, *Crocus tommasinianus* 'Barrs Purple', *Crocus vernus* 'Jeanne d'Arc', *Crocus sativus*, *Muscari armeniacum*, *Galanthus nivalis*, *Narcissus* 'Jack Snipe', *Muscari armeniacum*, *Narcissus jonquilla*, *Narcissus recurvus*, *Hyacinthoides non-scriptus**
- M1 - Wild Flower Meadow**
An appropriate dry meadow type with wildflowers for these areas would simulate NVC type MGS. Appropriate herbs for this type of meadow include:
- Agrostis capillaris*, *anthoxanthum odoratum*, *centaurea nigra*, *cyinusurus cristatus*, *pestuca rubra*, *gallium verum*, *leontodon autumnalis*, *leontodon hispidus*, *leucanthemum vulgare*, *lotus corniculatus*, *pimpinella saxifraga*, *plantago lanceolata*, *poa pratensis*, *primula veris*, *trifolium pratense*, *ranunculus acris*, *ranunculus bulbosus*, *rhinanthus minor*, *rumex acetosa*
- S1 - Shrub Planting: Public Areas** (450mm topsoil depth)
- | Common Name | Species Name | Specification | Centres |
|--------------------------|--|--------------------|---------|
| Dogwood | <i>Cornus sanguinea</i> * | c/g 3L 60-90cm ht. | 600mm |
| Autumn Fern | <i>Dryopteris erythrosora</i> | c/g 2L 30-40cm ht. | 350mm |
| Gold-Edged Plantain Lily | <i>Hosta fortunei</i> var. <i>aureomarginata</i> | c/g 2L 20-30cm ht. | 350mm |
| 'St. John's wort' | <i>Hypericum perforatum</i> * | c/g 2L 40-60cm ht. | 350mm |
| French Lavender | <i>Lavandula pedunculata</i> | c/g 3L 20-30cm ht. | 450mm |
| Snowy Mermaid | <i>Libertia formosa</i> * | c/g 2L 30-40cm ht. | 450mm |
| Chinese fountain grass | <i>Pennisetum alopecuroides</i> | c/g 2L 40-60cm ht. | 450mm |

Public Amenity Space - sc. 1:200



- S2 - Residential Edging Buffer** (450mm topsoil depth)
- | Common Name | Species Name | Specification | Centres |
|--------------------|--|--------------------|---------|
| Arrowwood | <i>Viburnum x bodnantense</i> | b/r 60-90cm ht. | 700mm |
| Guelder Rose | <i>Viburnum opulus</i> ** | b/r 60-90cm ht. | 700mm |
| Dogwood | <i>Cornus sanguinea</i> * | b/r 60-90cm ht. | 700mm |
| Ribbon Grass | <i>Phalaris feesei</i> | c/g 5L 20-30cm ht. | 400mm |
| Karl F. Reed Grass | <i>Calamagrostis</i> 'Karl Foerster' | c/g 2L 30-40cm ht. | 700mm |
| Miscanthus | <i>Miscanthus sinensis</i> 'Gracillimus' | c/g 2L 30-40cm ht. | 700mm |
| Lonicera | <i>Lonicera pileata</i> | c/g 2L 20-30cm ht. | 500mm |
- S3 - Residential Edging Buffer w/ Textured Screening** (450mm topsoil depth)
- | Common Name | Species Name | Specification | Centres |
|--------------------|--|--------------------|---------|
| Arrowwood | <i>Viburnum x bodnantense</i> 'Dawn' | b/r 60-90cm ht. | 700mm |
| Guelder Rose | <i>Viburnum opulus</i> ** | b/r 60-90cm ht. | 700mm |
| Dogwood | <i>Cornus sanguinea</i> * | b/r 60-90cm ht. | 700mm |
| Ribbon Grass | <i>Phalaris feesei</i> | c/g 5L 20-30cm ht. | 400mm |
| Karl F. Reed Grass | <i>Calamagrostis</i> 'Karl Foerster' | c/g 2L 30-40cm ht. | 700mm |
| Miscanthus | <i>Miscanthus sinensis</i> 'Gracillimus' | c/g 2L 30-40cm ht. | 700mm |
| Lonicera | <i>Lonicera pileata</i> | c/g 2L 20-30cm ht. | 500mm |
| Stinking hellebore | <i>Helleborus foetidus</i> * | c/g 2L 20-30cm ht. | 300mm |
| Dogwood | <i>Cornus alba</i> ** | c/g 2L 30-40cm ht. | 500mm |
| Bell heather | <i>Erica cinerea</i> ** | c/g 2L 30-40cm ht. | 500mm |
| Alum Root | <i>Heuchera</i> 'Palace Purple' | c/g 2L 20-30cm ht. | 300mm |
| Mugwort | <i>Artemisia vulgaris</i> * | c/g 2L 30-40cm ht. | 400mm |
| Snowy Mermaid | <i>Athyrium filix-femina</i> * | c/g 2L 30-40cm ht. | 500mm |
| Curry plant | <i>Helichrysum italicum</i> | c/g 2L 30-40cm ht. | 400mm |

- HARD LANDSCAPE**
- Homezone Residential Roadway - Shared Surface - 8085sq.m**
Tarmacadam, hot rolled with red graphic chipping, with in-situ concrete kerbs
 - Main Roadway**
Tarmacadam, with in-situ concrete kerbs
 - Concrete Footpath**
In-situ concrete. Brushed with trowel edge finish with PC concrete kerbs.
 - Homezone Area Footpath - 5100 sq.m (to Engineer's Specification)**
Conflat Grouted Macadam or Marshall asphalt, hot rolled with light grey/white graphic chipping.
 - Compacted Gravel Surface - 939sq.m**
Ballyusk 10mm and down, or similar, as approved
 - Own Curtilage Parking - Permeable Surface - 1470 sq.m**
Tobemore Hydropave Pedestel Pavers, dim. 200x100x60mm, colour Heather (Parking Dividers to be Silver, Stretcher bond pattern, or similar, as approved.
 - Roadside Parking - Permeable Surface - 1300 sq.m**
Tobemore Hydropave Pedestel Pavers, dim. 200x100x60mm, colour Natural (Parking Dividers to be Charcoal), Stretcher bond pattern, or similar, as approved.
 - Cycle Path - 5211 sq.m (to Engineer's Specification)**
Tarmacadam, colour to be decided, or similar, as approved
 - Tabled Intersection (to Engineer's Specification)**
- LANDSCAPE FURNITURE / FEATURES**
- Benches - 60 no.** Final locations to be determined
Hartecast HC2001S Bench or similar, as approved. Length 1950mm, width 540mm, height 450mm, powder coated steel, fixed to the ground by means of anchoring bolts
 - Found Play Elements**
Natural Play Elements - mounding, stepping stones, balance logs, vertical logs, as agreed prior to taking in charge
 - Structured Play Elements**
Multi-age play Elements
 - Painted Games**
Thermoplastic painted games on concrete

REV	DATE	BY	CHECKED	DESCRIPTION
L	15/02/21	PL	RMD	Planning Update
K	18/12/20	PL	RMD	Planning Update
J	23/11/20	PL	RMD	Planning Update
I	03/11/20	PL	RMD	Planning Update
H	21/10/20	PL	RMD	Planning Update
G	25/09/20	PL	RMD	Planning
F	17/09/20	PL	RMD	Planning Draft
E	19/08/20	PL	RMD	Planning Draft
D	23/06/20	MIR	RMD	Revised Layout
C	05/02/20	MOT	RMD	Revised Layout
B	30/09/19	MIR	RMD	Revised Layout - Engineer Overlay
A	16/09/19	MIR	RMD	Revised Layout

Project Title:	Lissywoolen, Athlone	Dwg No.:	DWG 2.6
Client:	Alanna Roadbridge Developments	Scale:	Varies
Drawing Title:	Landscape Details - Habitat Buffer	Date:	15/02/21
Job No.:	1463		

Ronan MacDiarmada + Associates Ltd.
Landscape Architects and Consultants.

5 Tootenhill, Rathcoole, Co. Dublin
tel: +353 1 412 4476 mob: 086 26 25 438
fax: +353 1 401 3748 e-mail: ronan@mda.ie

This Drawing is Copyright ©